

# 1. MACHINE FRAME & TENSION PARTS COMPONENTS

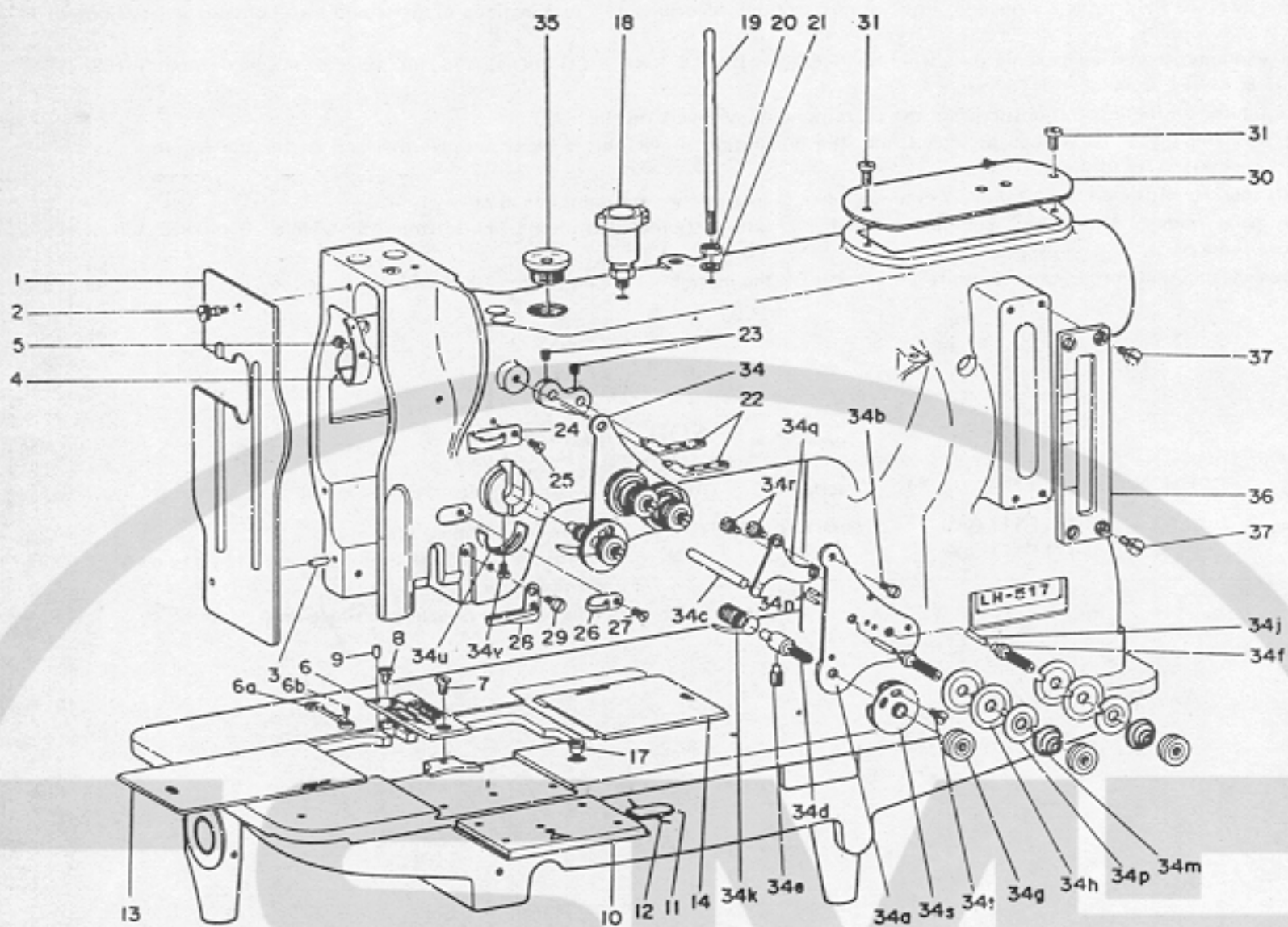

Ref. No.	Part No.	Description	Amt. Req.	Ref. No.	Part No.	Description	Amt. Req.
1	B-3101-517-000	Face plate	1	34	B-3121-051-0A0	Tension controller asm.	1
2	B-3106-019-000	. . . Screw	1	34a	B-3121-051-000	Thread tension controller base	1
3	B-1103-051-000	. . . Pin	1	34b	SS-7110720-SP	. . . Screw	1
4	B-1140-051-000	Arm oil shield	1	34c	B-3122-051-000	Tension release bar	1
5	SS-3090610-SP	. . . Screw	1	34d	B-3123-051-000	Thread take-up spring stud	1
6	B-1109-517-800	Throat plate (B)	1	34e	SS-8111251-SP	. . . Screw	1
6a	B-1115-517-800	Gauge	1	34f	B-3124-051-000	Thread tension post	2
6b	SS-4060310-SP	. . . Screw	2	34g	B-3125-012-000	Thread tension post nut	3
7	SS-2110920-TP	. . . Screw	1	34h	B-3126-051-000	Thread tension disc	4
8	SS-6090630-SP	. . . Guide screw	1	34j	B-3127-051-000	Thread tension release pin	2
9	B-1104-051-000	. . . Pin	1	34k	B-3128-051-000	Thread take-up spring	1
10	B-1110-051-000	Bed slide, front	1	34m	B-3129-051-000	Thread tension spring	2
11	B-1111-051-00A	. . . Stopper	1	34n	B-3131-051-000	Thread tension disc stopper	2
12	B-1111-051-00B	. . . Spring	1	34p	B-3132-051-000	Thread tension release washer	2
13	B-1112-512-E00	Bed slide, left	1	34q	B-3134-051-000	Thread tension release lever	1
14	B-1113-512-E00	Bed slide, right	1	34r	SD-0470281-SP	. . . Screw	2
17	B-1157-009-0A0	Oil cup, small	3	34s	B-3137-051-0A0	Thread take-up spring guide asm.	1
18	B-1155-053-000	Oil cup, large	1		B-3137-051-00A	. . . Stud	1
19	B-1114-517-000	Needle thread guide pin	1		B-3137-051-00B	. . . Disc, rear	1
20	NS-6620310-SP	. . . Nut	1		B-3137-051-00C	. . . Shaft	1
21	WP-0520656-SA	. . . Washer	1		B-3137-051-00D	. . . Disc, front	1
22	B-1128-051-000	Three-hole thread eyelet	2	34t	SS-4080610-SP	. . . Screw	1
23	SS-8110510-SP	. . . Screw	2	34u	B-3138-051-000	Thread take-up spring adjusting plate	1
24	B-1129-051-000	Frame thread guide, upper	1	34v	SS-7090520-SP	. . . Screw	1
25	SS-2090710-SP	. . . Screw	1	35	B-3501-051-000	Oil filler sleeve	1
26	B-1130-051-000	Frame thread guide, middle	1	35	B-1647-517-000	Stitch graduator	1
27	SS-2090710-SP	. . . Screw	1	37	SS-6080510-TP	. . . Screw	4
28	B-1131-051-000	Frame thread guide, lower	1				
29	SS-2090710-SP	. . . Screw	1				
30	B-1150-517-000	Top plate	1				
31	SS-7621040-SP	. . . Screw	2				

## 2. MAIN SHAFT & THREAD TAKE-UP LEVER COMPONENTS

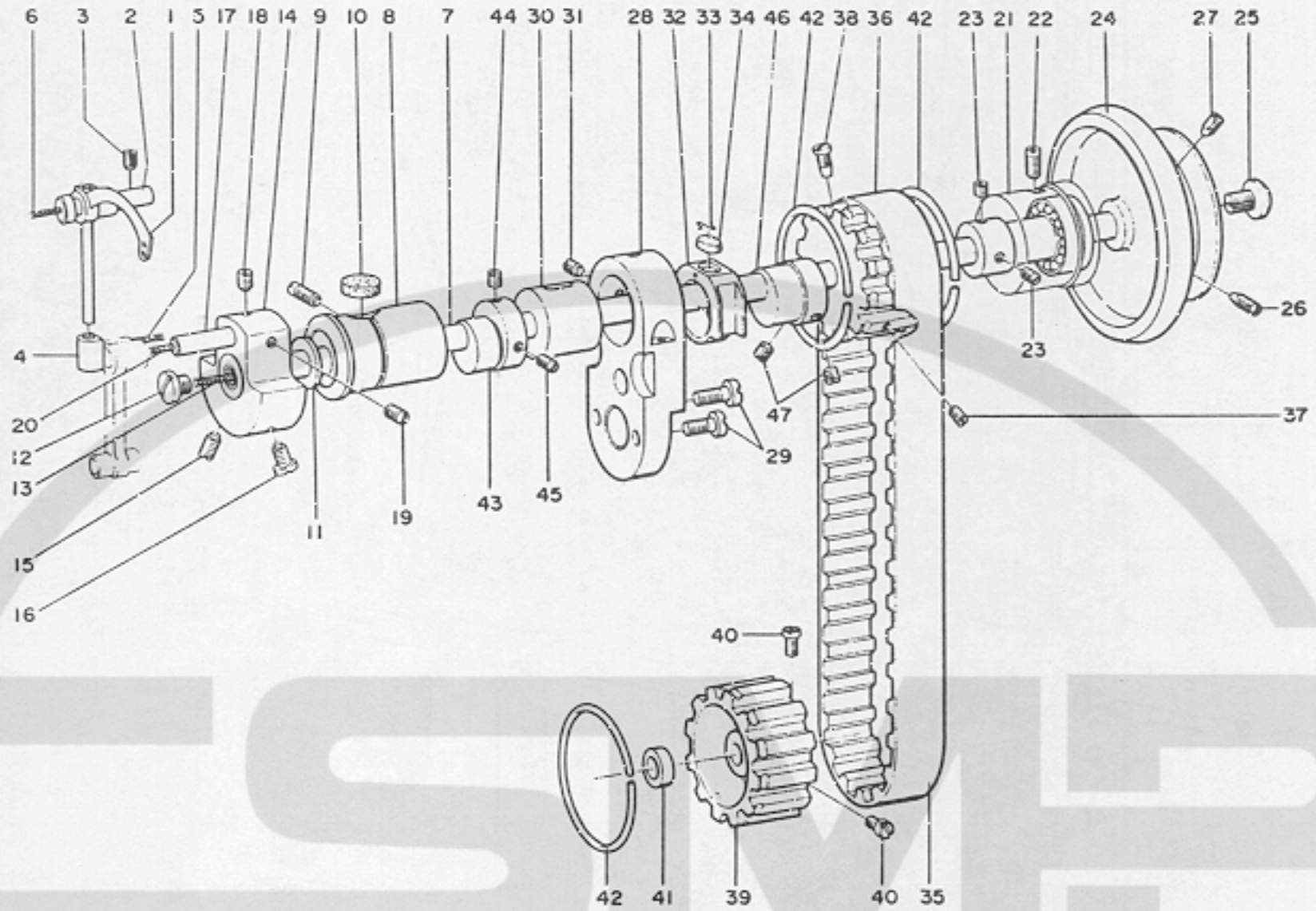

Ref. No.	Part No.	Description	Amt. Req.	Ref. No.	Part No.	Description	Amt. Req.
1	B-1905-517-000	Thread take-up lever	1	23	SS-8150710-SP	... Screw, for bushing (2)	2
2	B-1906-517-000	... Pin	1	24	B-1227-053-000	Hand wheel	1
3	SS-8151150-SP	... Screw 1	1	25	B-1233-012-000	... End screw	1
4	B-1907-051-000	... Thrust pin	1	26	SS-8151780-SP	... Screw (S)	1
5	B-1204-051-000	... Oil wick	1	27	SS-8152030-SP	... Screw	1
6	B-1204-051-000	... Oil wick, for pin	1	28	B-1226-517-000	Base, for intermediate bushing	1
7	B-1201-055-800	Main shaft	1	29	SS-7161640-SP	... Screw	2
8	B-1202-051-000	... Bushing, front	1	30	B-1203-232-000	Intermediate bushing	1
9	SS-8151150-SP	... Screw 1	1	31	SS-8151150-SP	... Screw	1
10	B-1203-051-000	... Oil felt	1	32	B-1211-517-000	Feed drive eccentric retainer housing	1
11	B-1205-051-000	... Thrust washer	1	33	B-1213-012-000	... Felt presser	1
12	B-1207-051-000	... Plug screw	1	34	B-1218-012-000	... Felt	1
13	B-1204-051-000	... Oil wick 1	1	35	B-1301-051-000	Timing belt	1
14	B-1206-051-000	Counterweight	1	36	B-1302-517-000	Sprocket wheel, upper	1
15	SS-8681650-TP	... Screw	1	37	SS-8681650-TP	... Screw (A)	1
16	SS-7681750-TP	... Screw (S)	1	38	SS-7681750-TP	... Screw (B)	1
17	B-1210-051-000	Needle bar crank pin	1	39	B-1303-051-A00	Sprocket wheel, lower	1
18	SS-8680540-SP	... Screw (1)	1	40	SS-7661110-TH	... Screw	2
19	SS-8680730-SP	... Screw (2)	1	41	B-1304-517-000	... Collar	1
20	B-1204-051-000	... Oil wick 1	1	42	B-1214-019-000	... Ring	3
*21	B-1216-051-0A0	Main shaft rear bushing asm.	1	43	B-1450-517-000	Knife driving cam	1
	B-1216-051-000	Main shaft rear bushing (1)	①	44	SS-8660530-TP	... Screw (A)	1
	B-1217-051-000	Main shaft rear bushing (2)	①	45	SS-8660970-SK	... Screw (B)	1
	B-1218-051-000	... Bearing retaining collar	①	46	B-1620-517-000	Feed eccentric cam	1
	B-1219-051-000	... Bearing	①	47	SS-8151150-SP	... Screw	2
22	SS-8151150-SP	... Screw, for bushing (1)	1				

### 3. NEEDLE BAR FRAME & FEED ROCK SHAFT COMPONENTS

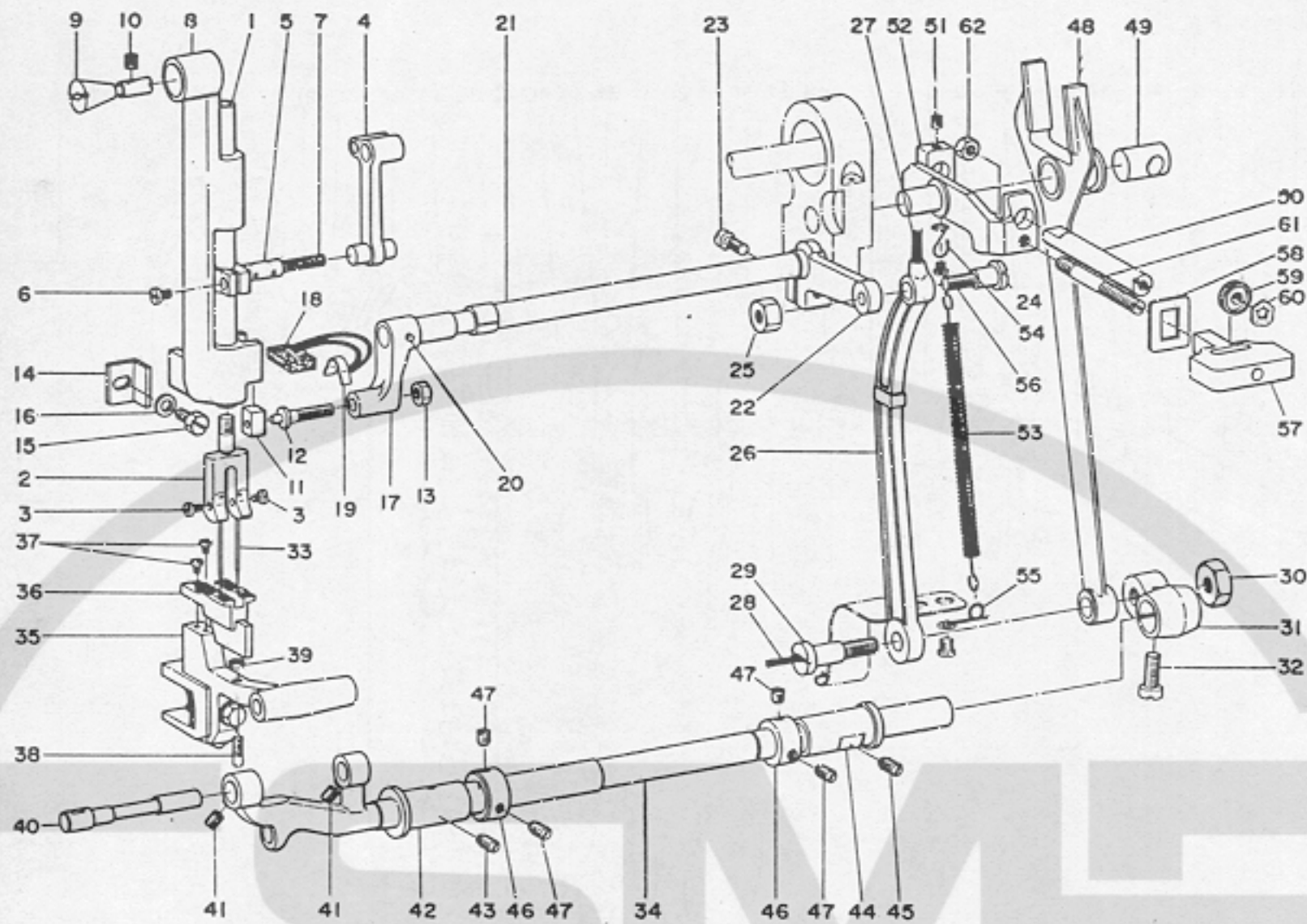

Ref. No.	Part No.	Description	Amt. Req.	Ref. No.	Part No.	Description	Amt. Req.
1	B-1401-517-B00	Needle bar	1	*35	B-1602-051-0A0	Feed bar asm.	1
2	B-1402-517-B00	Needle clamp	1		B-1602-051-000	Feed bar	①
3	SS-6090410-TP	Needle set screw	2		B-1604-051-000	... Slide fork	①
4	B-1408-051-000	Needle bar crank connecting rod	1		B-1605-051-000	... Oil felt	①
5	B-1411-051-000	Needle bar connection	1		SS-6080610-TP	... Screw	①
6	SS-7090910-SP	... Screw	1		SS-9151440-CP	... Screw	①
7	B-1412-051-000	... Oil felt	1		WP-0621016-SD	... Washer	①
8	B-1420-517-B00	Needle bar frame	1	36	B-1613-517-000	Feed dog	1
9	B-1421-051-000	... Taper stud	1	37	SS-6080720-SP	... Screw	2
10	SS-8151160-SP	... Screw	1	38	SS-8081450-SP	... Adjusting screw	1
11	B-1425-051-000	... Slide block	1	39	NS-6080210-SP	... Adjusting nut	1
12	B-1426-051-000	... Stud	1	40	B-1603-051-000	Feed bar shaft	1
13	NS-6620310-SP	... Nut	1	41	SS-8110510-SP	... Screw	2
14	B-1423-051-000	... Guide	1	42	B-1607-051-000	Feed rock shaft front bushing	1
15	SS-9111010-SP	... Screw	1	43	SS-8151150-SP	... Screw	1
16	WP-0480856-SP	... Washer	1	44	B-1609-051-000	Feed rock shaft rear bushing	1
17	B-1428-051-000	... Rock shaft crank, front	1	45	SS-8152030-SP	... Screw	1
*18	B-1438-051-0A0	... Oil wick asm.	1	46	CS-1401012-SC	Thrust collar, for feed rock shaft	2
19	B-1437-051-000	... Oil wick retainer	1	47	SS-8150410-SP	... Screw	4
20	PT-0301600-S0	... Pin	1	48	B-1614-517-000	Forked rod	1
21	B-1429-051-000	... Rock shaft	1	49	B-1618-517-000	... Pin	1
22	B-1431-517-000	... Rock shaft crank, rear	1	50	B-1619-517-000	... Guide shaft	1
23	SS-6151220-SP	... Clamp screw	1	51	SS-8110520-TP	... Screw	1
24	SD-0790801-SP	... Hinge screw	1	52	B-1615-517-000	Feed graduation plate	1
25	NS-6160520-SP	... Nut	1	53	B-3419-027-000	... Tension spring	1
26	B-1434-517-000	... Rock shaft driving rod	1	54	B-1617-517-000	... Suspension hook	1
27	B-1204-051-000	... Oil wick	1	55	B-1628-517-000	... Suspension hook, lower	1
28	B-1204-051-000	... Oil wick, for hinge screw	1	56	SS-7090710-SP	... Screw	1
29	SD-0951801-SP	... Hinge screw	1	57	B-1622-517-000	Feed lever	1
30	NS-6700420-SP	... Nut	1	58	B-1623-517-000	... Washer	1
31	B-1435-517-000	... Crank	1	59	B-1624-517-000	... Adjusting nut	1
32	SS-6151920-SP	... Screw	1	60	WZ-0641510-KP	... Washer	1
33	MDP-170B1600	Needle	2	61	B-1627-517-000	Feed regulating screw	1
34	B-1601-051-000	Feed rock shaft	1	62	NS-6150310-SP	... Lock nut	1

#### 4. PRESSER BAR & KNIFE COMPONENTS

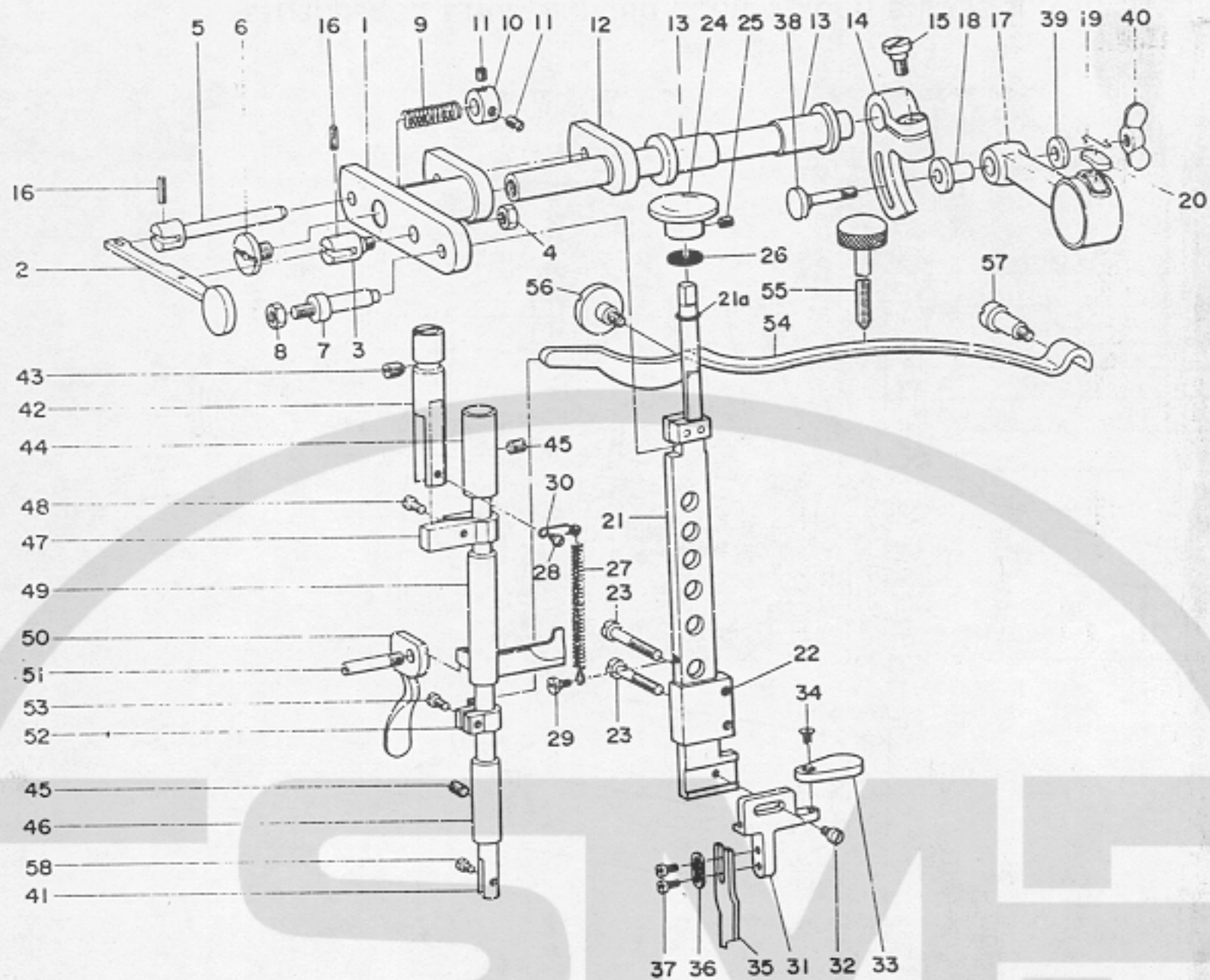

Ref. No.	Part No.	Description	Amt. Req.	Ref. No.	Part No.	Description	Amt. Req.
1	B-1453-517-000	Knife driving shaft base	1	29	SD-0420251-SA	... Screw, lower	1
2	B-1458-517-000	Knife driving lever	1	30	B-1473-517-000	... Suspension bracket	1
3	B-1460-517-000	... Guide	1	31	B-1468-517-000	Knife installing base	1
4	NS-6150310-SP	... Nut	1	32	SS-7090710-SP	... Screw	1
5	B-1455-517-000	... Guide stud	1	33	B-1469-517-000	... Lever	1
6	B-1461-517-000	End screw	1	34	SS-1090410-SL	... Screw	1
7	B-1459-517-000	Stud, for base	1	35	B-1475-517-800	Knife	1
8	NS-6150310-SP	... Nut,	1	36	B-4122-052-000	... Washer	1
9	B-2311-019-000	Spring, for base	1	37	SS-4080610-SP	... Screw	2
10	CS-0640863-SH	... Thrust collar	1	38	D-1456-055-800	Connecting stud, for knife driving rod	1
11	SS-8110750-SP	... Screw	2	39	D-1457-055-800	... Washer	1
12	B-1456-517-000	Knife driving shaft	1	40	D-1458-055-800	... Nut	1
13	B-1455-053-000	... Bushing	2	41	B-1501-517-800	Presser bar	1
14	B-1454-517-000	... Crank	1	42	B-1502-517-800	... Guide sleeve	1
15	SS-7161640-SP	... Clamp screw	1	43	SS-8150750-SP	... Screw	1
16	PS-0200122-K0	Pin, for knife driving lever guide	2	44	B-1503-051-A00	... Bushing, upper	1
17	B-1453-055-800	Knife driving rod	1	45	SS-8151150-SP	... Screw	2
18	D-1455-055-800	... Connecting stud	1	46	B-1503-051-800	... Bushing, lower	1
19	B-1213-012-000	... Oil felt presser	1	47	B-1504-051-000	... Guide, for bracket	1
20	B-1702-012-000	... Oil felt	1	48	SS-7090910-SP	... Screw	1
*21	B-1472-517-0A0	Knife driving plate asm.	1	49	B-1511-051-000	Hand lifter lever	1
	B-1471-517-000	Knife driving plate guide	①	50	B-1512-051-000	Hand lifter	1
	B-1472-517-000	Knife driving plate	①	51	B-1515-051-000	... Pin	1
	SS-3090810-SL	Screw, for knife driving plate guide	②	52	B-1507-051-000	Presser bar guide bracket	1
21a	RO-0442401-00	"O" ring	1	53	SS-7090910-SP	... Screw	1
22	B-1465-517-000	Knife driving plate holder	1	54	B-1505-053-000	Presser bar plate spring	1
23	SS-7113110-SP	... Clamp screw	2	55	B-1509-051-000	... Adjusting screw	1
24	B-1470-517-000	Knife driving plate finger tip	1	56	SD-0800481-SP	Hinge screw, for hand lifter lever	1
25	SS-8110750-SP	... Screw	1	57	SD-0801601-SP	Hinge screw, for plate spring	1
26	E-5025-001-000	... Rubber cushion	1	58	SS-6090910-TP	Presser foot set screw	1
27	B-1476-517-000	Tension spring	1				
28	SS-5060410-SP	... Screw, upper	1				

## 5. VERTICAL-AXIS SEWING HOOK & HOOK DRIVING SHAFT COMPONENTS

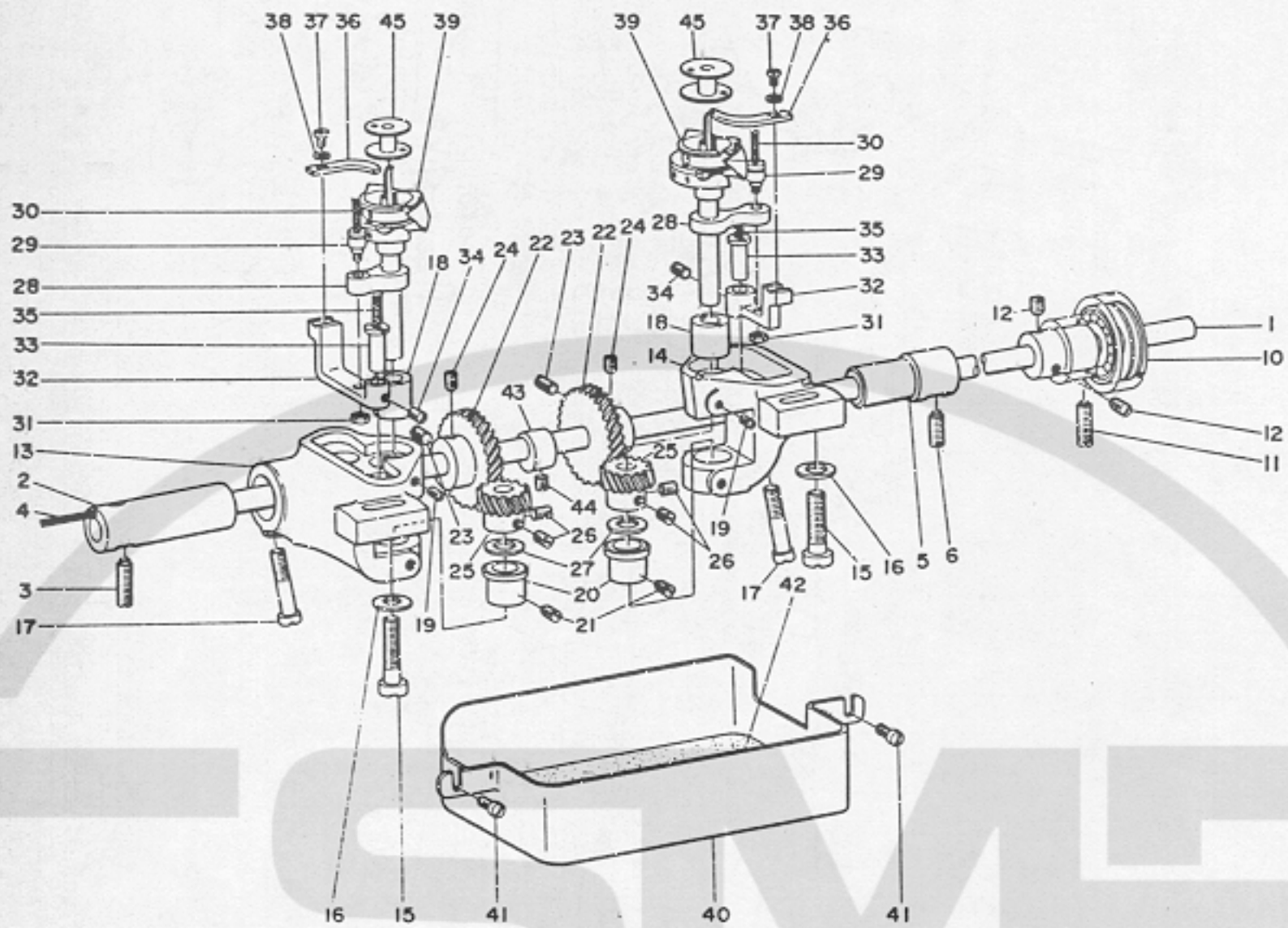

Ref. No.	Part No.	Description	Amt. Req.	Ref. No.	Part No.	Description	Amt. Req.
1	B-1801-051-000	Hook driving shaft	1	28	B-1820-051-000	Bobbin case opening lever link	2
2	B-1802-051-000	. . . Bushing, front	1	29	B-1821-051-000	Screw stud, for bobbin case opening lever crank	2
3	SS-8152030-SP	. . . . . Screw	1	30	B-1204-051-000	. . . Oil wick	2
4	B-1825-051-000	. . . . . Oil wick	1	31	NS-6110420-SP	. . . Nut	2
5	B-1804-051-000	. . . Bushing, intermediate	1	32	B-1822-051-000	Bobbin case opening lever crank	2
6	SS-8151550-SP	. . . . . Screw	1	33	B-1823-051-000	. . . Pin	2
				34	SS-8151230-SP	. . . . . Screw	2
				35	B-1204-051-000	. . . . . Oil wick	2
*10	B-1807-051-0A0	. . . Bushing, rear asm.	1	36	B-1824-051-000	Bobbin case opening lever	2
	B-1807-051-000	. . . Bushing, rear (1)	①	37	SS-6090620-SP	. . . Screw	2
	B-1808-051-000	. . . Bushing, rear (2)	①	38	WP-0371010-SD	. . . Washer	2
	B-1809-051-000	. . . Retaining collar, for bearing	①	39	B-1830-051-0A0	Vertical-axis sewing hook	2
	B-1219-051-000	. . . Rear bearing	①	40	B-1839-051-000	Oil reservoir	1
	SS-8090530-TP	. . . Screw, for retaining collar	③	41	SS-7110410-SP	. . . Screw	2
11	SS-8152030-SP	. . . Screw, for rear bushing	1	42	B-1841-051-000	. . . Oil drip felt	1
12	SS-8150750-SP	. . . Screw, for rear bushing (2)	2	43	B-1840-051-000	Feed driving eccentric	1
13	B-1810-051-000	. . . Saddle, left	1	44	SS-8150580-SP	. . . Screw	1
14	B-1811-051-000	. . . Saddle, right	1	45	B-9117-051-000	Bobbin	2
15	SS-7762840-SP	. . . . . Screw	2				
16	WP-0753016-5Z	. . . . . Washer	2				
17	SS-6153040-SP	. . . . . Clamp screw	2				
18	B-1814-051-000	Upper bushing, for sewing hook shaft	1				
19	SS-8151150-SP	. . . Screw	2				
20	B-1815-051-000	Lower bushing, for sewing hook shaft	2				
21	SS-8150710-SP	. . . Screw	2				
22	B-1816-051-000	Sewing hook shaft gear, large	2				
23	SS-8660810-SP	. . . Screw	2				
24	SS-8660970-TP	. . . Screw	2				
25	B-1817-051-000	Sewing hook shaft gear, small	2				
26	SS-8660530-TP	. . . Screw	2				
27	B-1818-051-000	. . . Thrust washer	2				

## 6. KNEE LIFTER COMPONENTS

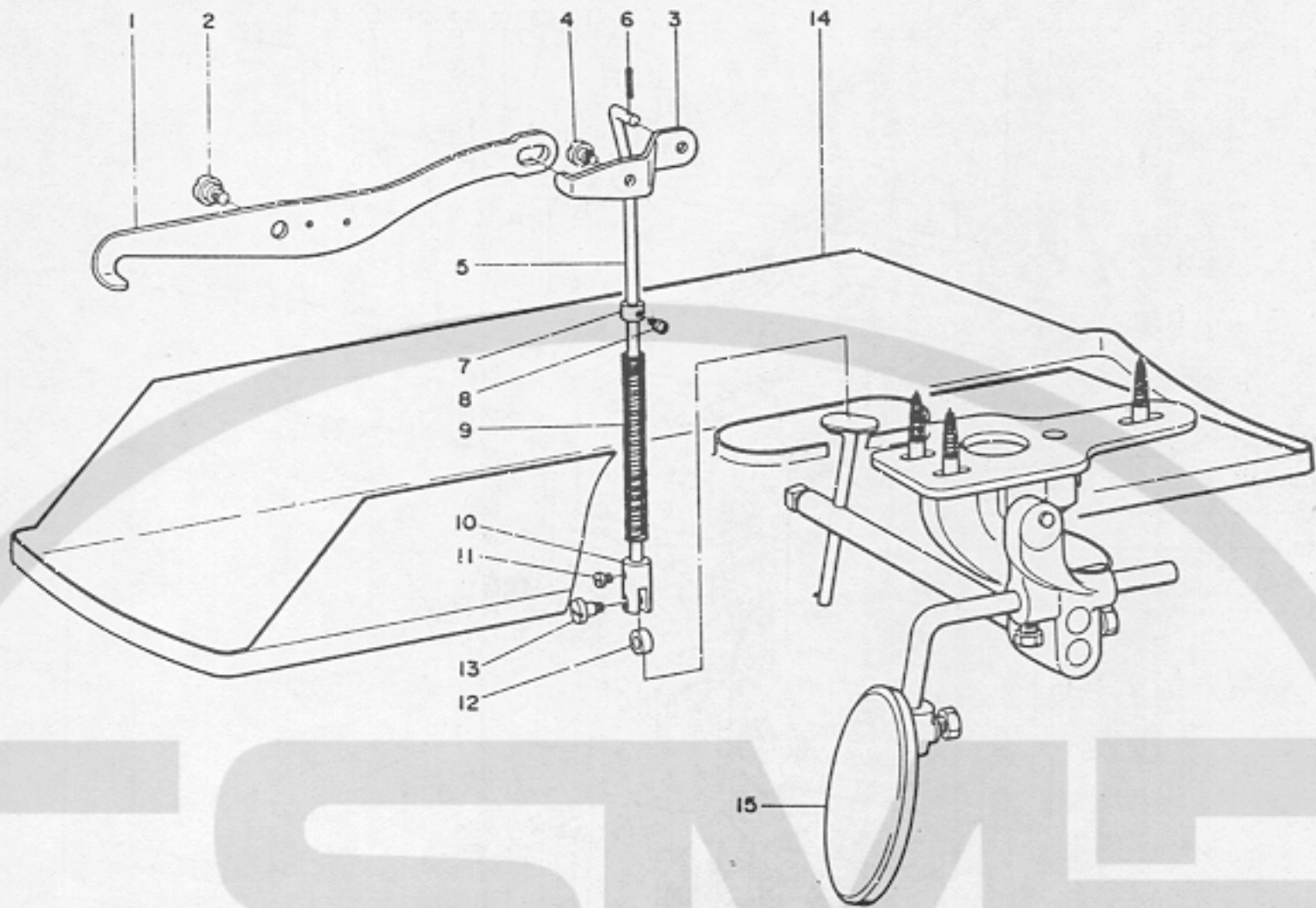

Ref. No.	Part No.	Description	Amt. Req.
1	B-3409-053-000	Knee lifting lever, front	1
2	SD-0790361-SP	. . . Hinge screw	1
3	B-3410-051-000	Knee lifting lever, rear	1
4	SD-0790361-SP	. . . Hinge screw	1
5	B-3413-053-000	Lifting lever connecting rod	1
6	PD-02311000B	. . . Pin	1
7	CS-0510713-SC	. . . Retainer, for spring	1
8	SS-7110540-SP	. . . . . Screw	1
9	B-3414-051-000	. . . Spring	1
10	B-3416-051-000	. . . Roller holder	1
11	SS-7110510-SP	. . . . . Screw	1
12	B-3417-051-000	. . . Roller	1
13	SD-0550801-SP	. . . . . Stud	1
14	B-8217-051-0A0	Oil reservoir asm.	1
15	B-3401-027-060	Knee press plate asm.	1

## 7. ELECTRICAL EQUIPMENT COMPONENTS (1)

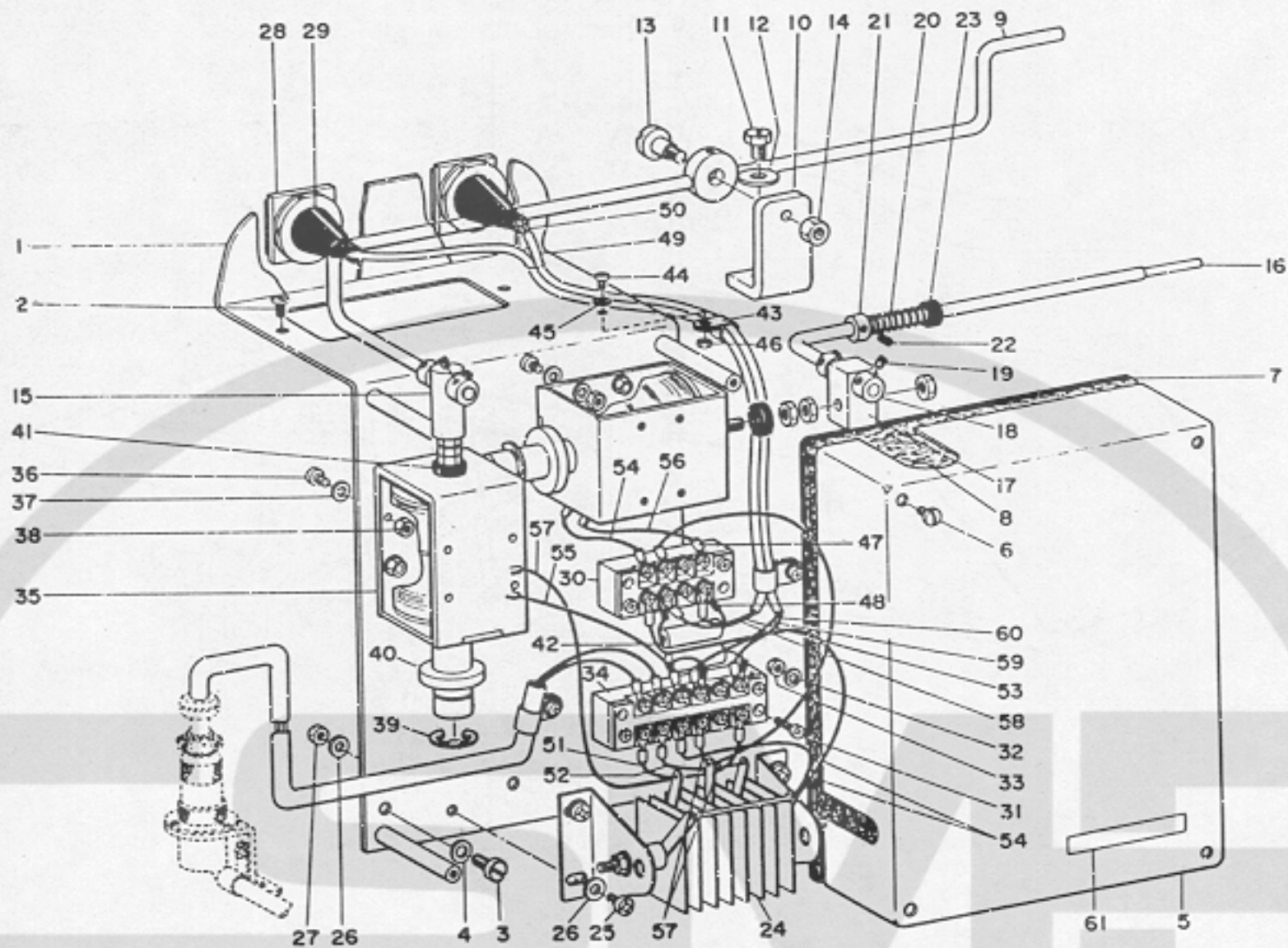

Ref. No.	Part No.	Description	Amt. Req.	Ref. No.	Part No.	Description	Amt. Req.
1	MAT-2020S00	Electrical equipment base asm.	1	31	SM-4031601-SB	... Screw	4
2	SS-76210410-SP	... Screw	2	32	WP-0330501-SB	... Washer	4
3	SS-9151120-CP	... Screw, lower	2	33	NM-6030000-SB	... Nut	4
4	WP-0621016-SD	... Washer	2	34	MAT-70143S00	Terminal base (6P)	1
5	MAT-20203S00	Control box cover	1	35	MAT-20224SA0	D.C solenoid	2
6	SS-5110740-TP	... Screw	4	36	SM-4041001-SB	... Screw	8
7	MAT-20210S00	... Sound-proof cushion (A)	1	37	WP-0450510-SB	... Washer	8
8	MAT-20211S00	... Sound-proof cushion (B)	1	38	NM-6040000-SB	... Nut	8
9	MAT-20204S00	Knife driving lever starting bar	1	39	RE-1200000-K0	... Rubber ring	2
10	MAT-20205S00	... Installing base	1	40	D-2468-555-800	... Sound-proof rubber cushion	2
11	MAT-20206S00	... Screw	1	41	E-5025-001-000	... Rubber cushion	2
12	WP-0850002-SD	... Washer	1	42	MAT-70141S00	Capacitor	2
13	SD-0741051-SP	... Hinge screw	1	43	E-4054-001-000	Cord holder	3
14	NS-6160520-SP	... Nut	1	44	SM-40430801-SB	... Screw	3
15	MAT-20207S00	... Connecting block	1	45	WP-0450510-SB	... Washer	3
16	MAT-20208S00	Knife driving lever release bar	1	46	NM-6040000-SB	... Nut	3
17	MAT-20209S00	... Connecting block	1	47	HP1A36PEC12	Terminal, large	20
18	CS-0640863-SH	... Thrust collar	4	48	HP1A30PAA12	Terminal, small	4
19	SS-8110510-SP	... Screw	8	49	E-5891-001-000	Vinyl tube, long	1m
20	B-2311-019-000	... Spring	1	50	E-9807-001-000	Vinyl tube, short	180mm
21	CS-0640863-SH	... Retaining collar	1	51	D-6017-555-800	Electric wire (white)	
22	SS-8110510-SP	... Screw	2	52	D-6018-555-800	Electric wire (black)	
23	E-5025001000	... Cushion	1	53	D-6019-555-800	Electric wire (red)	
24	MAT-20221SA0	Rectifier	1	54	D-6020-555-800	Electric wire (green)	
25	SM-4040810-SB	... Screw	4	55	D-6021-535-800	Electric wire (yellow)	
26	WP-0450510-SB	... Washer	8	56	D-6022-555-800	Electric wire (brown)	
27	NM-6040000-SB	... Nut	4	57	D-6023-555-800	Electric wire (blue)	
28	MAT-20222SA0	Push button switch	2	58	D-6075-555-800	Electric wire (grey)	
29	MAT-20226S00	... Cap	2	59	D-6076-555-800	Electric wire (orange)	
30	MAT-20223SA0	Terminal base (4P)	1	60	D-6077-555-800	Electric wire (purple)	

## 8. ELECTRICAL EQUIPMENT COMPONENTS (2)

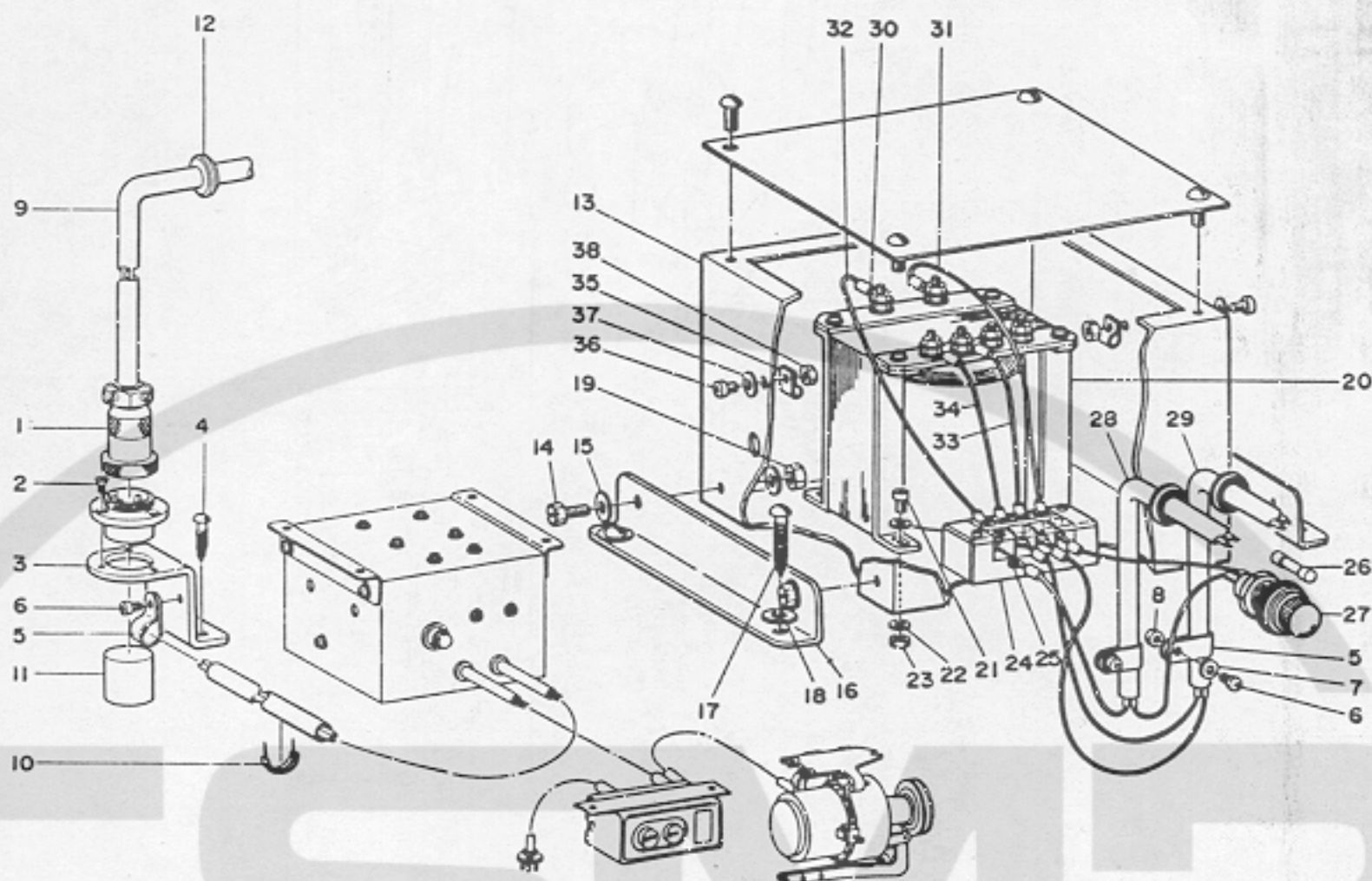

Ref. No.	Part No.	Description	Amt. Req.	Ref. No.	Part No.	Description	Amt. Req.
1	MAT-70144S00	Metal socket asm.	1	21	SM-4040810-SB	... Screw	4
2	SM-1030610-SB	... Screw	3	22	WP-0450510-SB	... Washer	8
3	MAT-70147S00	... Installing base	1	23	NM-6040000-SB	... Nut	4
4	SK-3482000-SC	... Screw	2	24	MAT-20223SA0	Terminal base (4P)	1
5	E-4054-001-000	Cord holder	3	25	HP1A36PEC12	Terminal, large	8
6	SM-4030610-SB	... Screw	3	26	MAT-70161S0B	Fuse	1
7	WP-0450510-SP	... Washer	2	27	MAO-11519A00	... Box	1
8	NM-6040000-SB	... Nut	2	28	MAT-20227S0A	Main cord (A)	1
9	MAT-70145S0B	Main cord (C)	1	29	MAT-20227S0B	Main cord (B)	1
10	MAO-11532000	Staple	10	30	D-6033-555-B00	Terminal, for transformer	4
11	E-5351-668-000	Tube	1	31	D-6017-555-B00	Electric wire (white)	
12	E-9644-001-000	Rubber cap	3	32	D-6018-555-B00	Electric wire (black)	
13	MAT-20225SA0	Transformer box	1	33	D-6019-555-B00	Electric wire (red)	
14	SS-9120910-TP	... Screw	4	34	D-6021-555-B00	Electric wire (yellow)	
15	WP-0621016-SD	... Washer	8	35	B-3536-122-000	Electric wire holder	2
16	MAT-20212S00	... Holder	2	36	SM-4040810-SB	... Screw	4
17	SK-3482500-SC	... Screw	4	37	WP-0450510-SB	... Washer	4
18	WP-0621016-SD	... Washer	4	38	NM-6040000-SB	... Nut	4
19	NS-6120310-SP	... Nut	4				
20	D-6038-555-B0B	Transformer	1				



## 9. PIPING FOLDER COMPONENTS

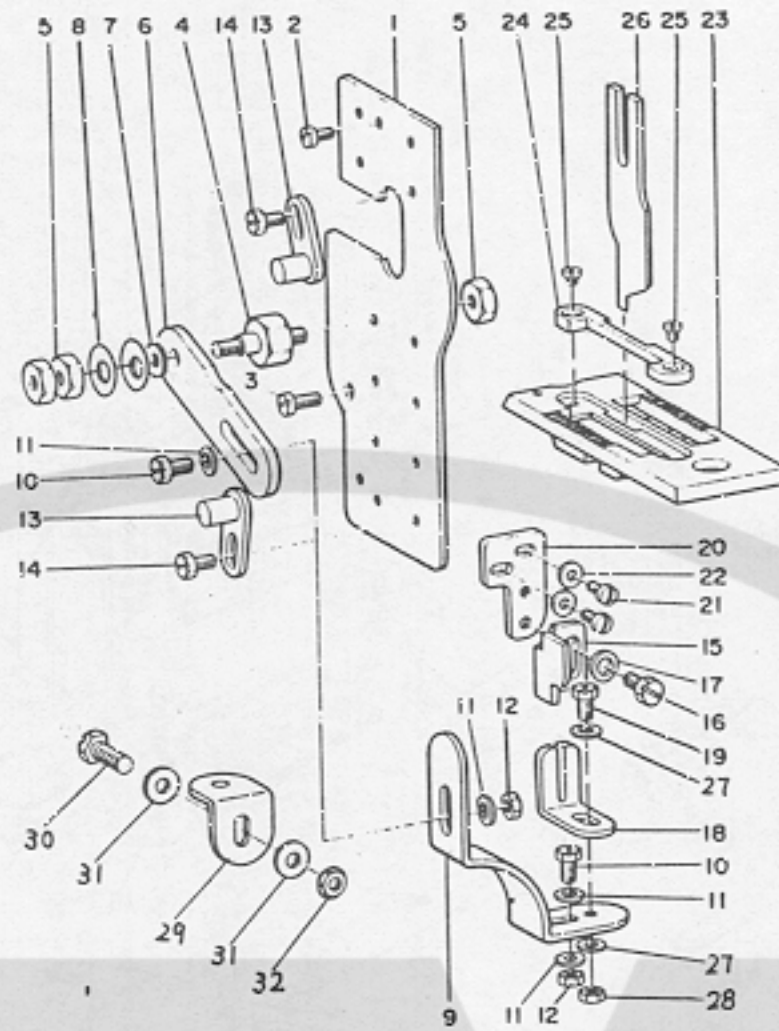

Ref. No.	Part No.	Description	Amt. Req.
1	B-3101-517-B00	Face plate (B)	1
2	SS-7090710-SL	. . . Screw (A)	1
3	SS-7151210-SP	. . . Screw (B)	1
4	B-3701-517-000	Folder installing stud	1
5	NS-6150430-SP	. . . Nut	3
6	B-3702-517-000	Folder installing plate (A)	1
7	WP-0751576-SD	. . . Washer	1
8	B-1121-232-000	. . . Spring washer	2
9	B-3703-517-000	Folder installing plate (B)	1
10	SS-9151440-CP	. . . Screw	2
11	WP-0621016-SD	. . . Washer	4
12	NS-6150430-SP	. . . Nut	2
13	B-3705-517-000	Stopper asm.	2
14	SS-9150730-SP	. . . Screw	2
15	B-3707-517-000	Folder holding plate	1
16	SS-9150730-SP	. . . Screw	1
17	WP-0651056-SD	. . . Washer	1
18	B-3708-517-000	. . . Retainer	1
19	SS-9151440-CP	. . . . . Screw	1
20	B-3709-517-000	. . . . . Installing plate	1
21	SS-7621040-SP	. . . . . Screw	2
22	WP-0520656-SA	. . . . . Washer	2
23	B-1109-517-B00	Throat plate (B)	1
24	B-1115-517-B00	Gauge	1
25	SS-4060310-SP	. . . Screw	2
26	B-1475-517-B00	Knife (B)	1
27	WP-0621016-SD	Washer, for folder holding plate	2
28	NS-6150430-SP	. . . Nut	1
29	B-3704-517-000	Folder installing plate C	1
30	SS-9151440-CP	Folder clamp screw	1
31	WP-0621016-SD	. . . Washer	2
32	NS-6150430-SP	. . . Nut	1

### 10. NUMERICAL INDEX OF PARTS

Part No.	Page	Ref. No.	Part No.	Page	Ref. No.	Part No.	Page	Ref. No.	Part No.	Page	Ref. No.	Part No.	Page	Ref. No.	
<b>EXCLUSIVE PARTS</b>															
B-1103-051-000	1	3	B-1429-051-000	3	21	B-1627-517-000	3	61	B-3702-517-000	9	6	MAT-20224SA0	7	35	
B-1104-051-000	1	9	B-1431-517-000	3	22	B-1628-517-000	3	55	B-3703-517-000	9	9	MAT-20225SA0	8	13	
B-1109-517-800	1	6	B-1434-517-000	3	26	B-1647-517-000	1	36	B-3704-517-000	9	29	MAT-20226S00	7	29	
B-1109-517-800	9	23	B-1435-517-000	3	31	B-12 18-012-000	2	34	B-3705-517-000	9	13	MAT-20227SOA	8	28	
B-1110-051-000	1	10	B-1437-051-000	3	19	B-1702-012-000	4	20	B-3707-517-000	9	15	MAT-20227SOB	8	29	
B-1111-051-00A	1	11	B-1438-051-0A0	3	*18	B-1801-051-000	5	1	B-3708-517-000	9	18				
B-1111-051-00B	1	12	B-1450-517-000	2	43	B-1802-051-000	5	2	B-3709-517-000	9	20				
B-1112-512-E00	1	13	B-1453-055-800	4	17	B-1804-051-000	5	5	B-4122-052-000	4	36				
B-1113-512-E00	1	14	B-1453-517-000	4	1				B-8217-051-0A0	6	14				
B-1114-517-000	1	19	B-1454-517-000	4	14	B-1807-051-000	5	10	B-9117-051-000	5	45				
B-1115-517-800	1	6a	B-1455-053-000	4	13	B-1807-051-0A0	5	*10	D-1455-055-800	4	18	MAT-70141S00	7	42	
B-1115-517-800	9	24	B-1455-517-000	4	5	B-1808-051-000	5	10	D-1456-055-800	4	38	MAT-70143S00	7	34	
B-1121-232-000	9	8	B-1456-517-000	4	12	B-1809-051-000	5	10	D-1457-055-800	4	39	MAT-70144S00	8	1	
B-1128-051-000	1	22	B-1458-517-000	4	2	B-1810-051-000	5	13	D-1458-055-800	4	40	MAT-70145S0B	8	9	
B-1129-051-000	1	24	B-1459-517-000	4	7	B-1811-051-000	5	14	D-2468-555-800	7	40	MAT-70147S00	8	3	
B-1130-051-000	1	26	B-1460-517-000	4	3	WP-0753016-S2	5	16	D-6017-555-800	7	51	MAT-70161S0B	8	26	
B-1131-051-000	1	28	B-1461-517-000	4	6	B-1814-051-000	5	18	D-6017-555-800	8	31				
B-1140-051-000	1	4	B-1465-517-000	4	22	B-1815-051-000	5	20	D-6018-555-800	7	52	NEEDLE			
B-1150-517-000	1	30	B-1468-517-000	4	31	B-1816-051-000	5	22	D-6018-555-800	8	32	MDP-170B1600	3	33	
B-1155-053-000	1	18	B-1469-517-000	4	33	B-1817-051-000	5	25	D-6019-555-800	7	53				
B-1157-009-0A0	1	17	B-1470-517-000	4	24	B-1818-051-000	5	27	D-6019-555-800	8	33	THRUST COLLAR			
B-1159-041-000	7	61	B-1471-517-000	4	21	B-1820-051-000	5	28	D-6020-555-800	7	54	CS-0510713-SC	6	7	
B-1201-055-800	2	7	B-1472-517-000	4	21	B-1821-051-000	5	29	D-6021-555-800	7	55	CS-0640863-SH	4	10	
B-1202-051-000	2	8	B-1472-517-0A0	4	*21	B-1822-051-000	5	32	D-6021-555-800	8	34	CS-0640863-SH	7	18	
B-1203-051-000	2	10	B-1473-517-000	4	30	B-1823-051-000	5	33	D-6022-555-800	7	56	CS-0640863-SH	7	21	
B-1203-232-000	2	30	B-1475-517-800	4	35	B-1824-051-000	5	36	D-6023-555-800	7	57	CS-1401012-SC	3	46	
B-1204-051-000	2	5	B-1475-517-800	9	26	B-1825-051-000	5	4	D-6033-555-800	8	30				
B-1204-051-000	2	6	B-1476-517-000	4	27	B-1830-051-0A0	5	39	D-6038-555-800	8	20	NUT			
B-1204-051-000	2	13	B-1501-517-800	4	41	B-1839-051-000	5	40	D-6075-555-800	7	58	NM-6030000-SB	7	33	
B-1204-051-000	2	20	B-1502-517-800	4	42	B-1840-051-000	5	43	D-6076-555-800	7	59	NM-6040000-SB	7	27	
B-1204-051-000	3	27	B-1503-051-A00	4	44	B-1841-051-000	5	42	D-6077-555-800	7	60	NM-6040000-SB	7	38	
B-1204-051-000	3	28	B-1503-051-800	4	46	B-1905-517-000	2	1	E-4054-001-000	7	43	NM-6040000-SB	7	46	
B-1204-051-000	5	30	B-1504-051-000	4	47	B-1906-517-000	2	2	E-4054-001-000	8	5	NM-6040000-SB	8	8	
B-1204-051-000	5	35	B-1505-053-000	4	54	B-1907-051-000	2	4	E-5025-001-000	4	26	NM-6040000-SB	8	23	
B-1205-051-000	2	11	B-1507-051-000	4	52	B-2311-019-000	4	9	E-5025-001-000	7	23	NM-6040000-SB	8	38	
B-1206-051-000	2	14	B-1509-051-000	4	55	B-2311-019-000	7	20	E-5025-001-000	7	41	NS-6080210-SP	3	39	
B-1207-051-000	2	12	B-1511-051-000	4	49	B-3101-517-000	1	1	E-5351-568-000	8	11	NS-6110420-SP	5	31	
B-1210-051-000	2	17	B-1512-051-000	4	50	B-3101-517-800	9	1	E-5891-001-000	7	49	NS-6120310-SP	8	19	
B-1211-517-000	2	32	B-1515-051-000	4	51	B-3106-019-000	1	2	E-9644-001-000	8	12	NS-6150310-SP	3	62	
B-1213-012-000	2	33			B-3121-051-000	1	34a	E-9807-001-000	7	50	NS-6150310-SP	4	4		
B-1213-012-000	4	19			B-3121-051-0A0	1	*34	HP1A30PAA12	7	48	NS-6150310-SP	4	8		
B-1214-019-000	2	42			B-3122-051-000	1	34c	HP1A36PEC12	7	47	NS-6150430-SP	9	5		
B-1216-051-000	2	21			B-3123-051-000	1	34d	HP1A36PEC12	8	25	NS-6150430-SP	9	12		
B-1216-051-0A0	2	*21			B-3124-051-000	1	34f	MAO-11519A00	8	27	NS-6150430-SP	9	28		
B-1217-051-000	2	21			B-3125-012-000	1	34g	MAO-11532000	8	10	NS-6150430-SP	9	32		
B-1218-051-000	2	21			B-3126-051-000	1	34h								
B-1219-051-000	2	21			B-3127-051-000	1	34j								
B-1219-051-000	5	10			B-3128-051-000	1	34k				NS-6160520-SP	3	25		
B-1226-517-000	2	28			B-3129-051-000	1	34m				NS-6160520-SP	7	14		
B-1227-053-000	2	24			B-3131-051-000	1	34n				NS-6620310-SP	1	20		
B-1233-012-000	2	25			B-3132-051-000	1	34p				NS-6620310-SP	3	13		
B-1301-051-000	2	35	B-1601-051-000	3	34	B-3134-051-000	1	34q				NS-6700420-SP	3	30	
B-1302-517-000	2	36	B-1602-051-000	3	35	B-3137-051-00A	1	34s							
B-1303-051-A00	2	39	B-1602-051-0A0	3	*35	B-3137-051-00B	1	34s				PIN			
B-1304-517-000	2	41	B-1603-051-000	3	40	B-3137-051-00C	1	34s				PD-02311000B	6	6	
B-1316-055-000	2	40	B-1604-051-000	3	35	B-3137-051-00D	1	34s				PS-0200122-K0	4	16	
B-1401-517-800	3	1	B-1605-051-000	3	35	B-3137-051-0A0	1	*34s	MAT-20203S00	7	5	PT-0301600-S0	3	20	
B-1402-517-800	3	2	B-1607-051-000	3	42	B-3138-051-000	1	34u	MAT-20204S00	7	9	RUBBER RING			
B-1408-051-000	3	4	B-1609-051-000	3	44	B-3401-027-080	6	15	MAT-20205S00	7	10	RE-1200000-K0	7	39	
B-1411-051-000	3	5	B-1613-517-000	3	36	B-3409-053-000	6	1	MAT-20206S00	7	11	RO-0442401-00	4	21a	
B-1412-051-000	3	7	B-1614-517-000	3	48	B-3410-051-000	6	3	MAT-20207S00	7	15				
B-1420-517-800	3	8	B-1615-517-000	3	52	B-3413-053-000	6	5	MAT-20208S00	7	16	HINGE SCREW			
B-1421-551-000	3	9	B-1617-517-000	3	54	B-3413-051-000	6	9	MAT-20209S00	7	17	SD-0420251-SA	4	29	
B-1423-051-000	3	14	B-1618-517-000	3	49	B-3416-051-000	6	10	MAT-20210S00	7	7	SD-0470281-SP	1	34r	
B-1425-051-000	3	11	B-1619-517-000	3	50	B-3417-051-000	6	12	MAT-20211S00	7	3	SD-0550801-SP	6	13	
B-1426-051-000	3	12	B-1620-517-000	2	46	B-3419-027-000	3	53	MAT-20212S00	8	16	SD-0741051-SP	7	13	
B-1428-051-000	3	17	B-1622-517-000	3	57	B-3501-051-000	1	35	MAT-20221SA0	7	24	SD-0790361-SP	6	2	
			B-1623-517-000	3	58	B-3536-122-000	8	35	MAT-20222SA0	7	28	SD-0790361-SP	6	4	
			B-1624-517-000	3	59	B-3701-517-000	9	4	MAT-20223SA0	7	30	SD-0790801-SP	3	24	
								MAT-20223SA0	8	24	SD-0800481-SP	4	56		
											SD-0801601-SP	4	57		

Part No.	Page	Ref. No.	Part No.	Page	Ref. No.
SD-0951801-SP	3-29		SS-8110510-SP	7-22	
SCREW			SS-8110750-SP	4-11	
SK-3482000-SC	8-4		SS-8110750-SP	4-25	
SK-3482500-SC	8-17		SS-8111251-SP	1-34e	
SM-1030610-SB	8-2		SS-8150410-SP	3-47	
SM-4030610-SB	8-6		SS-8150580-SP	5-44	
SM-4031601-SB	7-31		SS-8150710-SP	2-23	
SM-4040810-SB	7-25		SS-8151230-SP	5-21	
SM-4040810-SB	8-21		SS-8150710-SP	5-34	
SM-4040810-SB	8-36		SS-8150750-SP	4-43	
SM-4041001-SB	7-36		SS-8150750-SP	5-12	
SM-4030801-SB	7-44		SS-8151150-SP	2-3	
SS-1090410-SL	4-34		SS-8151150-SP	2-31	
SS-2090710-SP	1-25		SS-8151150-SP	2-47	
SS-2090710-SP	1-27		SS-8151150-SP	3-43	
SS-2090710-SP	1-29		SS-8151150-SP	4-45	
SS-2110920-TP	1-7		SS-8151150-SP	5-19	
SS-3090610-SP	1-5		SS-8151160-SP	3-10	
SS-3090810-SL	4-21		SS-8151350-SP	2-9	
SS-4060310-SP	1-66		SS-8151350-SP	2-22	
SS-4060310-SP	9-25		SS-8151550-SP	5-6	
SS-4080610-SP	1-34t		SS-8151780-SP	2-26	
SS-5060410-SP	4-28		SS-8152030-SP	2-27	
			SS-8152030-SP	3-45	
			SS-8152030-SP	5-3	
SS-5110740-TP	7-6		SS-8152030-SP	5-11	
			SS-8660530-TP	2-44	
SS-6060410-TP	9-39		SS-8660530-TP	5-26	
SS-6080610-TP	1-37		SS-8660810-SP	5-23	
SS-6080610-TP	3-35		SS-8660970-SK	2-45	
SS-6080710-SP	4-37		SS-8660970-TP	5-24	
SS-6080720-SP	3-37		SS-8680540-SP	2-18	
SS-6090410-TP	3-3		SS-8680730-SP	2-19	
SS-6090620-SP	5-37		SS-8681650-TP	2-15	
SS-6090630-SP	1-8		SS-8681650-TP	2-37	
SS-6090910-TP	4-58		SS-9111010-SP	3-15	
SS-6151220-SP	3-23		SS-9120910-TP	8-14	
SS-6151920-SP	3-32		SS-9150730-SP	9-14	
SS-6153040-SP	5-17		SS-9150730-SP	9-16	
SS-7090520-SP	1-34v		SS-9151120-CP	7-3	
SS-7090520-SP	5-9				
SS-7090610-SP	5-8		SS-9151440-CP	9-10	
SS-7090710-SP	3-56		SS-9151440-CP	9-19	
SS-7090710-SP	4-32		SS-9151440-CP	3-35	
SS-7090710-SL	9-2		SS-9151440-CP	9-30	
			WASHER		
SS-7090910-SP	3-6		WP-0330501-SB	7-32	
SS-7090910-SP	4-48		WP-0371010-SD	5-38	
SS-7090910-SP	4-53		WP-0450510-SB	7-26	
SS-7110410-SP	5-41		WP-0450510-SB	7-37	
SS-7110510-SP	6-11		WP-0450510-SB	7-45	
SS-7110540-SP	6-8		WP-0450510-SP	8-7	
SS-7110720-SP	1-34b		WP-0450510-SB	8-22	
SS-7113110-SP	4-23		WP-0480856-SP	8-37	
SS-7151210-SP	9-3		WP-04808560SP	3-16	
SS-7161640-SP	2-29		WP-0520656-SA	1-21	
SS-7161640-SP	4-15		WP-0520656-SA	9-22	
SS-7621040-SP	1-31				
SS-7621040-SP	7-2		WP-0621016-SD	3-35	
SS-7621040-SP	9-21		WP-0621016-SD	7-4	
			WP-0621016-SD	8-15	
SS-7681750-TP	2-16		WP-0621016-SD	8-18	
SS-7681750-TP	2-38		WP-0621016-SD	9-11	
SS-7762840-SP	5-15				
SS-8081450-SP	3-38		WP-0621016-SD	9-27	
SS-8090530-TP	5-10		WP-0621016-SD	9-31	
SS-8110510-SP	1-23		WP-0651056-SD	9-17	
SS-8110510-SP	3-41		WP-0751576-SD	9-8	
SS-8110520-TP	3-51		WP-0850002-SD	7-12	
SS-8110510-SP	4-25		WZ-0641510-KP	3-60	
SS-8110510-SP	7-19				